

NOCCHI MAX

MULTI-CELL SELF-PRIMING CENTRIFUGAL PUMPS

The self-priming pumps in the MAX range combine the advantages and practical features of centrifugal pumps with the functionality of self-priming pumps. The self-priming system and multi-stage hydraulics guarantee optimal hydraulic performance and impressive suction capacity, maintaining priming even in the presence of air or gas bubbles trapped in the water.

MOTOR

- Closed, ventilated from exterior.
- Protection rating IP 44.
- Insulation class F.
- Single phase power supply with permanently activated capacitor and thermal cutout protection incorporated in the motor winding.
- Three phase power supply with external protection to be fitted by the user.
- Rotation speed 2850 rpm.
- Continuous duty.

APPLICATIONS

- Lifting and distribution of water in domestic systems.
- Pressure booster systems.
- Fire fighting systems.
- Washing, irrigation.

APPLICATION DATA

- Type of liquid: clean water without suspended solid bodies or abrasive material.
- Maximum liquid temperature: 50°C.
- Maximum recommended suction height: 7 m with foot valve.
- Maximum operating pressure: 7 bar.

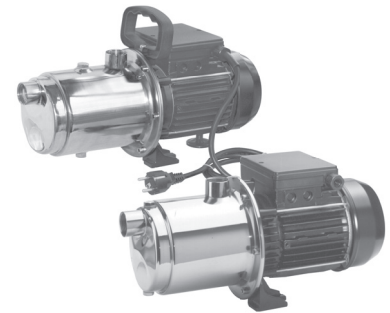
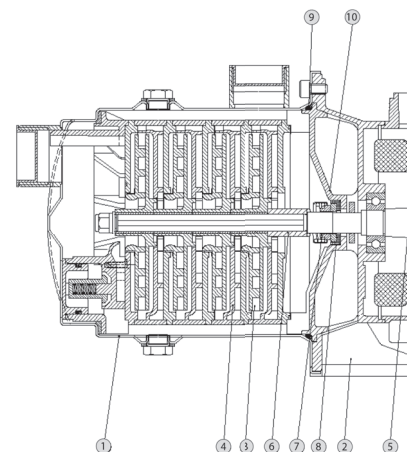

TABLE OF MATERIALS

Component		Material
1	Pump body	Stainless steel X5 CrNi 1810 (AISI 304)
2	Motor bracket	Die cast aluminum
3	Impellers	Technopolymer with shim ring in stainless steel X5 CrNi 1810 (AISI 304)
4	Diffusers	Technopolymer
5	Shaft (hydraulic section)	Stainless steel X5 CrNi 1810 (AISI 304)
6	Spacer	Nickel-plated brass OT 58
7	Mechanical gasket	Graphite
8	Counterface	Ceramic
9	Seals	NBR 70 Shore
10	Seal holder base	Noryl GFN2V



NOCCHI MAX

MULTI-CELL SELF-PRIMING CENTRIFUGAL PUMPS

HYDRAULIC PERFORMANCE

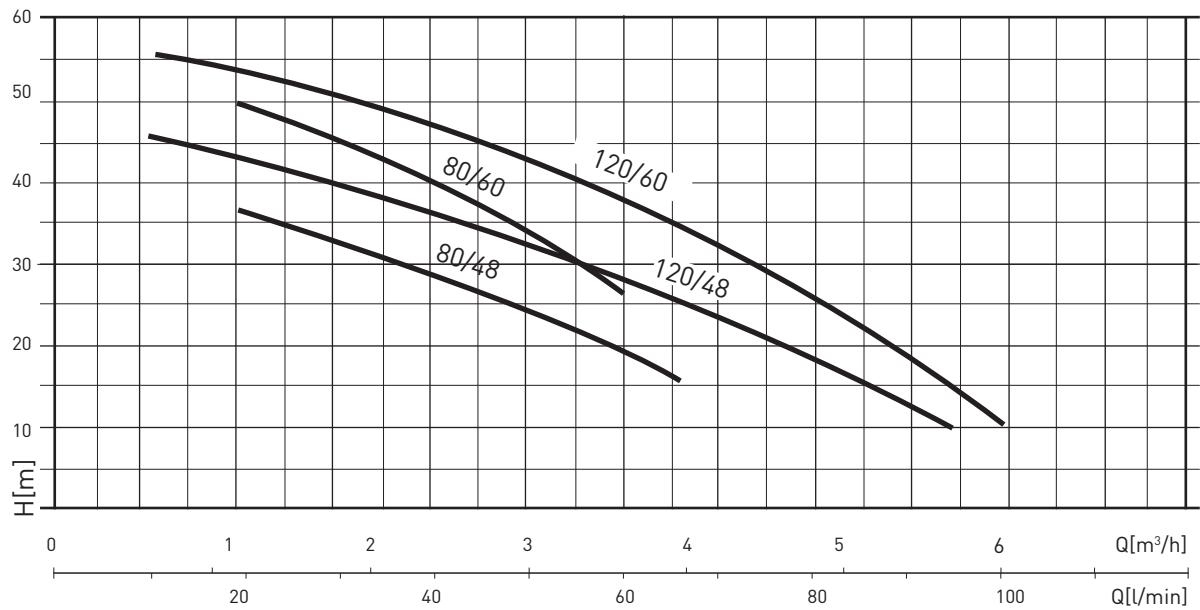

PERFORMANCE TABLE

MODEL	Motor output (P2)		Motor output (P1)		VOLT	In (A)	μF	Q	L/min m³/h	0	20	40	60	80	100
	HP	kW	HP	kW						0	1.2	2.4	3.6	4.8	6
MAX 80/48 M MAX 80/48 T MAX 80/48 C	0.75	0.55	1.1	0.8	1 ~ 230 V 3 ~ 230 - 400 V 1 ~ 230 V	4 2.6-1.5 4	12.5	m.c.a./m.w.c.	45	36	28	17	1		
MAX 80/60 M MAX 80/60 T	1	0.75	1.3	1	1 ~ 230 V 3 ~ 230 - 400 V	4.8 2.9-1.7	16		57	50	40	27	3		
MAX 120/48 M MAX 120/48 T	1	0.75	1.5	1.1	1 ~ 230 V 3 ~ 230 - 400 V	4.6 3.6-2.1	16		48	42	37	27	18	5	
MAX 120/60 M MAX 120/60 T MAX 120/60 C*	1.2	0.9	1.7	1.25	1 ~ 230 V 3 ~ 230 - 400 V 1 ~ 230 V	5.8 3.5-2 5.8	20		60	55	48	36	26	10	

* Version complete with cable, Schuko plug, handle and switch

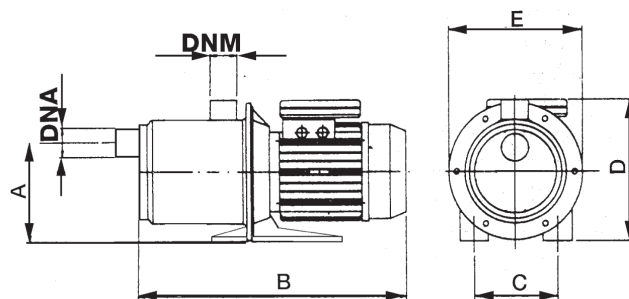

OVERALL DIMENSIONS AND WEIGHTS

MODEL	Dimensions (mm)							Weight (kg)
	A	B	C	D	E	DNA	DNM	
MAX 80/48	129	370	99	182	176	1"	1"	8
MAX 80/60	129	392	99	182	176	1"	1"	8
MAX 120/48	129	393	99	192	176	1"	1"	10
MAX 120/60	129	392	99	182	176	1"	1"	11