

# NOCCHI WP/Multi EVO-A

## PRESSURE BOOSTER UNITS WITH HORIZONTAL EXPANSION TANK

**NEW**2016  
PENTAIR

ACS

WATERPRESS pressure booster units are made with self-priming centrifugal MULTISTAGE electric pumps **Multi EVO-A**. They are supplied wired, complete with 24 l or 50 l expansion tank, ready for installation and use. All models are certified for use with household water (ACS).

### ADVANTAGES

- Reduces pressure waves
- Ideal for water supply systems in buildings
- Ready to use
- Reduction in start-up frequency with 50 l tank
- Very simple to install

### DESIGN FEATURES

- Electromechanical pressure switch (max 6 bar) calibrated to: min 2 ÷ max 3 bar.
- Pump start pressure adjustable from 1.5 to 3 bar
- Gauge (6 bar).
- 5-way valve in chrome-plated pressed brass.
- Expansion tanks:
  - 50 l expansion tank in painted steel (models WP / Multi EVO-A 3-40 M-50l and WP / Multi EVO-A 5-50 M-50 l).
  - 24 l expansion tank in painted steel (model WP / Multi EVO-A 3-40 M).
  - 24 l expansion tank in stainless steel (model WP / Multi EVO-A 5-50 M-SS)
- Tuboflex hydraulic connection.
- Power cable 1.5 m H05 RN-F with plug

### SPECIFICATIONS:

#### PUMP

- Type of liquid: clean water with no suspended solids or abrasive material
- Maximum liquid temperature 50°C
- Maximum suction height 8m with pump correctly installed
- Maximum operating pressure 8 bar

#### MOTOR

- Enclosed, externally ventilated (TEFC)
- 2 poles, 50 Hz (n=2850 rpm)
- Protection class IP 55
- Insulation class F
- Single phase power supply with permanently inserted condenser and thermal protection incorporated into motor winding
- Three-phase power supply with external protection supplied by the user



### APPLICATIONS

- Lifts and distributes water in domestic systems
- Pressurization systems
- Cleaning systems
- Irrigation



# NOCCHI WP/Multi EVO-A

## PRESSURE BOOSTER UNITS WITH HORIZONTAL EXPANSION TANK

### DESIGN FEATURES

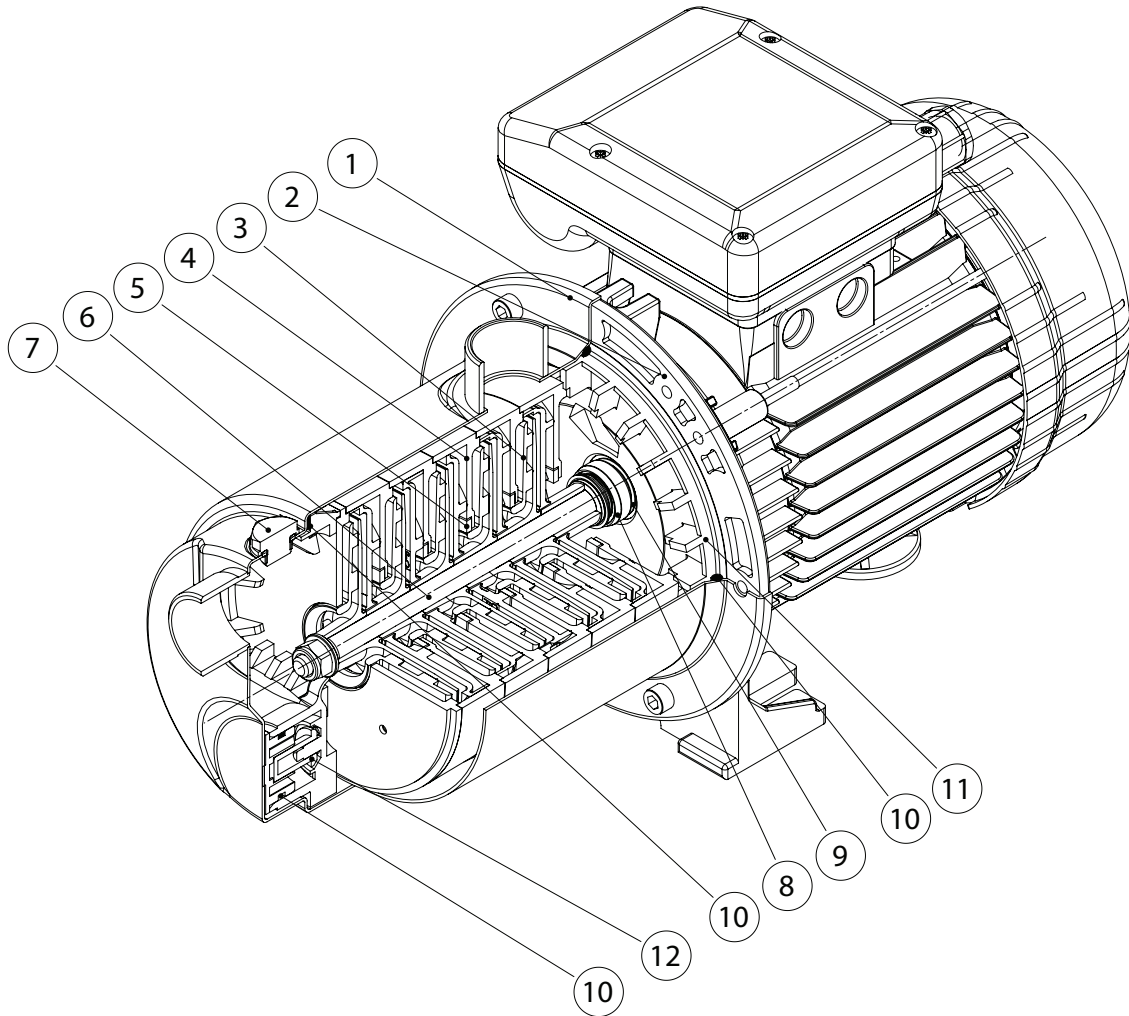

### TABLE OF MATERIALS

Ref.	Component	Material
1	Pump body	Stainless steel Europe: EN10088-1 X5CrNi18-10 (1.4301) USA: AISI 304
2	Motor casing	Die-cast aluminium
3	Impeller	Fibreglass reinforced PPO
4	Diffuser	Fibreglass reinforced PPO
5	Wear ring	PTFE
6	Shaft (hydraulic part)	Stainless steel Europe: EN10088-1 X5CrNi18-10 (1.4301) USA: AISI 304
7	Inlet / outlet caps	Stainless steel Europe: EN10088-1 X8CrNiS18-9 (1.4305) USA: AISI 303
8	Mechanical seal	Carbon graphite / NBR / SS Europe: EN10088-1 X5CrNi18-10 (1.4301) USA: AISI 304
9	Counterface	Ceramic / NBR
10	Gaskets	NBR 70 Shore A
11	Seal holder plate	Fibreglass reinforced PPO
12	Self-priming valve	Fibreglass reinforced PPO

# NOCCHI WP/Multi EVO-A 5

## PRESSURE BOOSTER UNITS WITH HORIZONTAL EXPANSION TANK

### HYDRAULIC PERFORMANCE

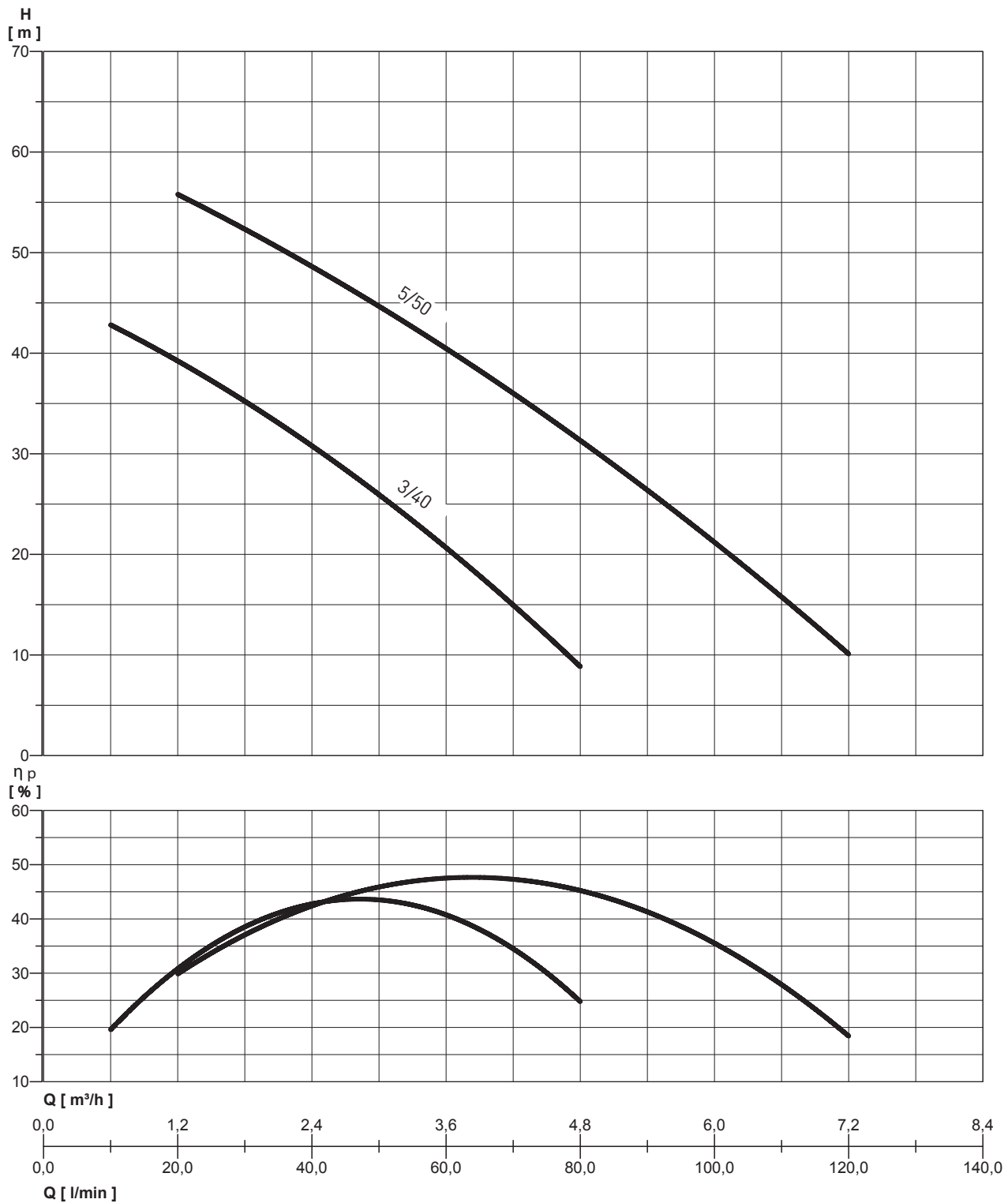

# NOCCHI WP/Multi EVO-A 5

## PRESSURE BOOSTER UNITS WITH HORIZONTAL EXPANSION TANK

### PERFORMANCE TABLE

MODEL	Nominal power (P2)		Absorbed power (P1)		Voltage (V)	In (A)	µF	Q	10	20	30	40	50	60	80	100	120	
	HP	kW	HP	kW					0,6	1,2	1,8	2,4	3	3,6	4,8	6	7,2	
WP / Multi EVO-A 3-40 M	0,67	0,5	1,1	0,8	1 ~ 230	3,7	12,5	total head in metres water column	42,5	39,5	35,5	31	25,5	20,5	9			
WP / Multi EVO-A 3-40 M-50l	0,67	0,5	1,1	0,8	1 ~ 230	3,7	12,5			56	52	48,5	45	40,5	31	21,5	10	
WP / Multi EVO-A 5-50 M-SS	1,34	1	1,8	1,35	1 ~ 230	6,2	20											
WP / Multi EVO-A 5-50 M-50l	1,34	1	1,8	1,35	1 ~ 230	6,2	20											

24 l

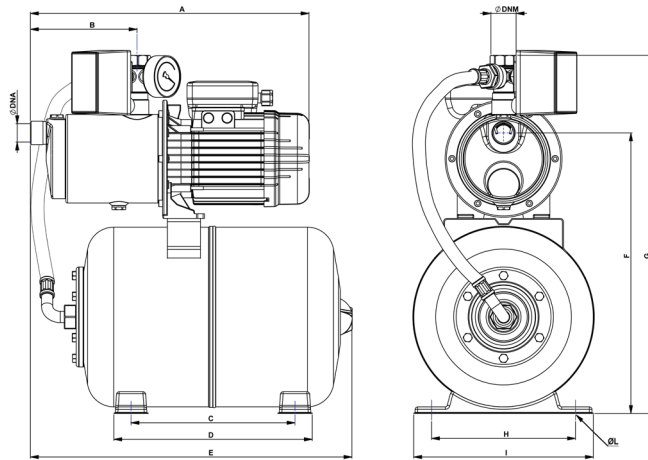

50 l

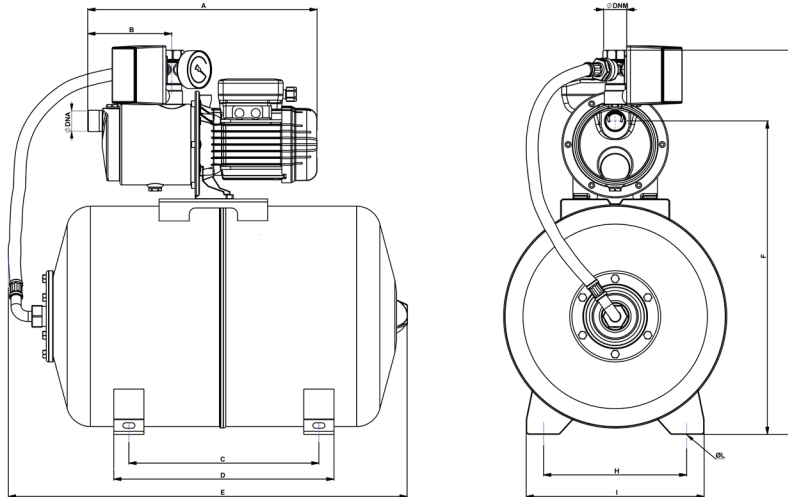

### OVERALL DIMENSIONS AND WEIGHTS

MODEL	Dimensions mm.												Weight (Kg)
	A	B	C	D	E	F	G	H	I	L	DNA	DNM	
WP / Multi EVO-A 3-40 M	380	139	245	295	495	410	530	190	240	9	1"	1"	13,6
WP / Multi EVO-A 3-40 M-50l	380	139	315	365	660	520	640	242	295	9	1"	1"	18
WP / Multi EVO-A 5-50 M-SS	422	162	248	300	490	435	540	218	272	11	1"	1"	14
WP / Multi EVO-A 5-50 M-50l	422	162	215	365	660	520	640	242	295	9	1"	1"	20,5